

# Sylvia Avenue

KNOWLE

APPROXIMATE FLOOR AREA  
135.4 SQM / 1457.5 SQFT



GROUND FLOOR



FIRST FLOOR



SECOND FLOOR

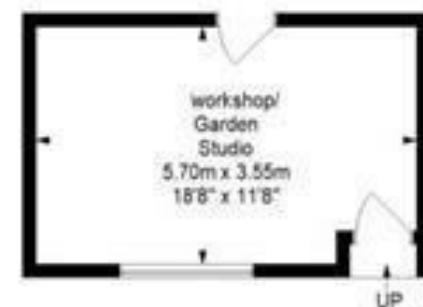

Boardwalk

# Sylvia Avenue , BRISTOL

£

£850,000



BS3 5BU

zZz

4 Bedrooms



2 Bathrooms

*"Our favourite thing about this home has to be the location, it's on a nice wide street and all the houses face the park, which is great for dog walks and watching the hot air balloons in summer. From all rooms in the front you can see Clifton Suspension Bridge, Park Street and beyond. We really love having a garden that floods with sun for around eight hours in summer, after which we go round to the front or the park to catch more sun. Also the loft room is great for our teenage daughter, as she has basically a studio flat."*

